

Type	DH-200-2R	Heating:	Cooling:
AIR:	Actual capacity	1,6	[kW]
	Safety on surface / capacity	-4,9 / -2,7	[%]
	Sensible heat ratio	1	
	Air flow rate	270	[m³/h]
	Inlet temperature	7	[°C]
	Inlet relative humidity	80	[%]
	Outlet temperature	25	[°C]
	Outlet relative humidity	25,3	[%]
	Actual air velocity	1	[m/s]
	Pressure drop	10	[Pa]
FLUID:	Condensed water	0	[kg/h]
	Water	100	[%]
	Inlet temperature	50	[°C]
	Outlet temperature	30	[°C]
	Liquid flow rate	71	[dm³/h]
	Pressure drop	1	[kPa]
	Actual fluid velocity	0,2	[m/s]

SKETCH: COIL CODE: HW-G20-02R-0270-0270-150-1×01C-24F-M1-C20-IS1-XX-1×R½/1×R½-150

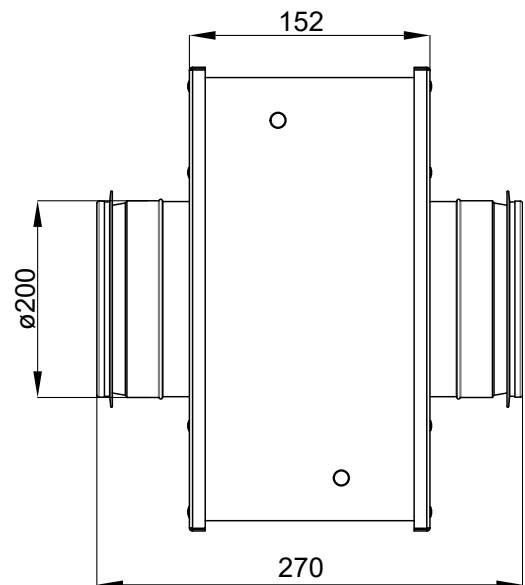
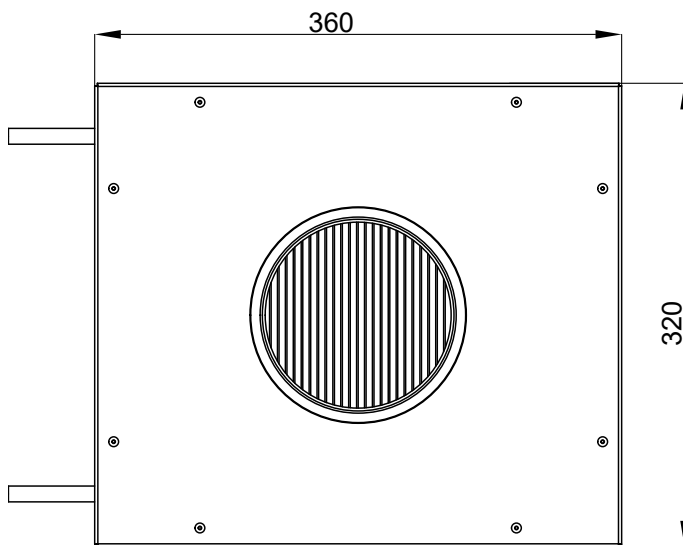

Technical features:

Connections inlet	pipe thread EN10226 1×R½	Weight	7 [kg]
Connections outlet	pipe thread EN10226 1×R½	Internal volume	1,1 [dm³]
Tubes, manifold	Cu	Exchange surface	2,9 [m²]
Fins	Al	Max. allowable pressure PED 97/23/CE	21 [bar]
Frame	FeZn	Min / Max allowable temperature	-21 / 130 [°C]
Connections	brass		